

The NAVALIBER-ISOLIBER wall panel can be used as a lining or partition for wet rooms inside accommodation areas.

The core panel is a high-density rock wool, lined on both sides by a 0,7 mm thickness galvanized sheet finished with a decorative low flame spread PVC foil on visible face. Colours according with project.

The system is completed with all the necessary profiles for the installation.

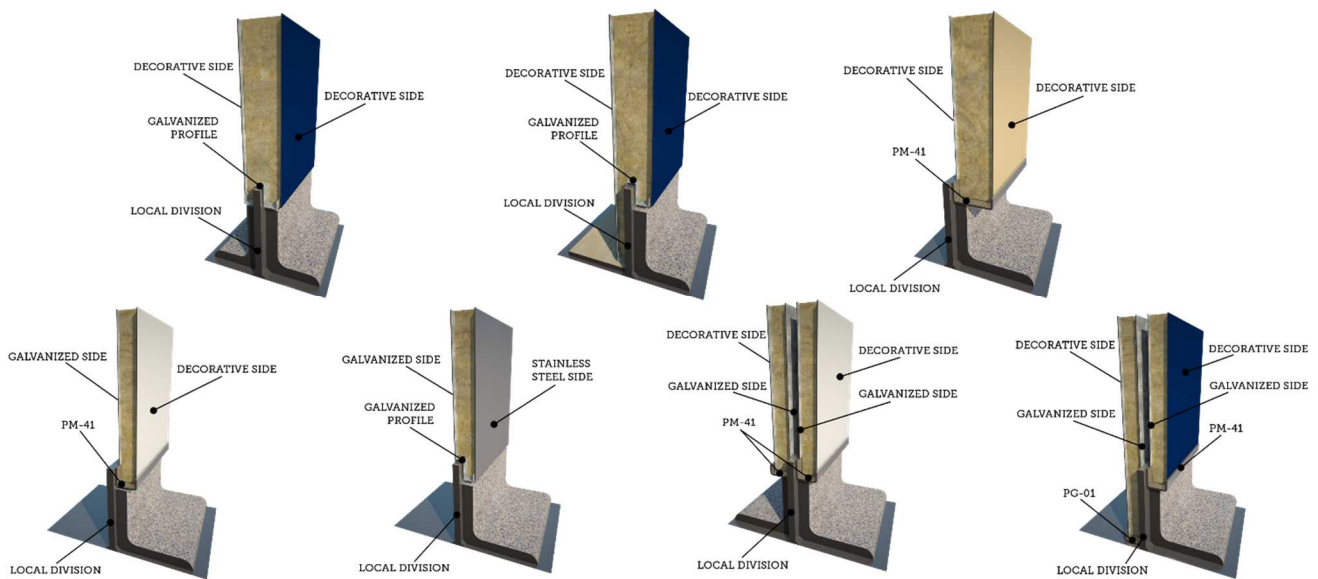

TECHNICAL FEATURES	25B-15	3B-15 acoustic — 38 dB	3B-15 acoustic — 40 dB
Linings	0,7 mm	0,7 mm	1 mm
Standard finishing	150 µm PVC film	150 µm PVC film	150 µm PVC film
Insulation	rock wool	rock wool	rock wool
Max. length	2500 mm	3000 mm	3000 mm
Standard width	600-935 mm	Max. 600 mm	Max. 600 mm
Thickness	25 mm	50 mm	50 mm
Weight	16 kg/m ²	19 kg/m ²	24 kg/m ²
Noise reduction	-	38 dB ⁽¹⁾	40 dB ⁽²⁾
Classification	B-15	B-15	B-15

¹ According to acoustic test ref. CTA 243/08/AER and method of test UNE-EN ISO 140-3:1995.

² According to acoustic test ref. CTA 244/08/AER and method of test UNE-EN ISO 140-3:1995.